

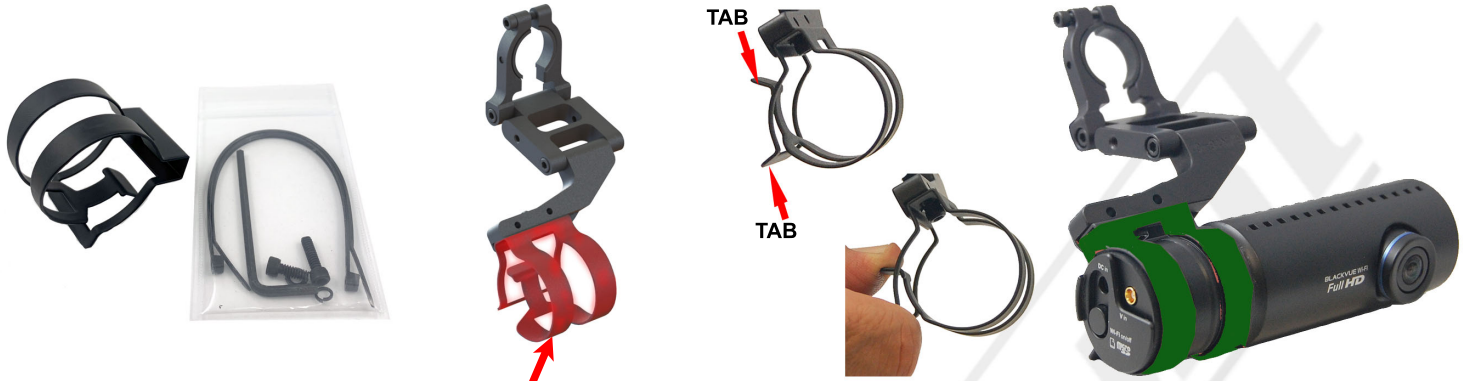

INSTALLATION INSTRUCTIONS FOR BLACKVUE DR750X Plus, DR900X Plus, DR900X , DR750X  
DR900S, DR750S, DR650S, DR650GW, DR600GW, DR590, DR490, DR470, DR450, DR430



1 - Remove BBL Clip of your existing mount, shown here in red.

2 - Install new adapter parts shown in green. To install dashcam into mount, simply squeeze the two tabs of the spring clip together as shown above. This will increase diameter of the spring clip and allow you to slide the dashcam into position. Once dashcam is in position, release the two tabs. The dashcam is now securely attached to the mount.

**CENTER LINK**

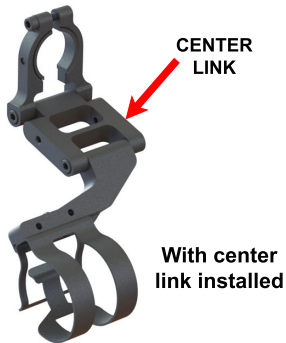

With center link installed



Without center link installed

3 - The center-link may be removed if an overall shorter mount length is needed, depending on your rear view mirror and desired position for the dashcam.

**BLENDMOUNT ADJUSTMENTS**



SPRING CLIP HORIZONTAL ADJUSTMENT SCREW

4 - Using the upper and lower pivot screws, adjust the mount to achieve your desired location of the dashcam. We recommend adjusting it as high as you can. You can also use the spring clip horizontal adjustment screw to help center the dashcam with the mirror as shown above.

FOR MORE INFO VISIT [www.blendmount.com/videos](http://www.blendmount.com/videos)

**CAUTION**

**DO NOT** use this mount if it interferes with the adjustability or the operation of your rear view mirror in any way.

**DO NOT** use this mount if the dashcam creates an unsafe viewing obstruction.

**DO NOT** ATTEMPT TO MODIFY THIS PRODUCT. Consult the manufacturer for assistance.

All BlendMount products are accompanied with detailed installation instructions and adjustment tips. You are encouraged to contact [customerservice@blendmount.com](mailto:customerservice@blendmount.com) or call J28 Design at 1-888-497-8388 for further assistance.

Check the BlendMount Forum for installation tips and some vehicle specific installs.

[www.blendmount.com](http://www.blendmount.com)

Your feedback is very important to us. Please email any questions or comments you have to [customerservice@blendmount.com](mailto:customerservice@blendmount.com)



**Innovative Design And  
Precision Manufacturing**

BlendMount - US PATENT # D625,580 S, D656,811 S, D653,980 S, D690,245 S, D690,246 S, D690,247 S and other patents pending